

General

A component of the Wybron Infotrace Series of Products

Color LCD display and 4 membrane buttons for user settings

Wide selection of fixture mounting plates

Integrated stainless steel safety cable

.063" aluminum sheet metal construction

Multiple operating personalities for different performance characteristics

Alternating vertical finshutter movement for smooth uniform light reduction

Shutter Speed-Cross-fade Up to 60 seconds
Fast cut: 200 milliseconds (five times a second)
Strobe rate: 10CPS - 100ms (at 60% amplitude)

Low fan speed for quiet operation

Accessory "ears" for color changers, diffusion panels, etc. are standard.

Accepts power and data on one cable

4 pin XLR connector for power and data

4 pin XLR connector output for daisy chaining units

Reverse polarity protection, unit will not be damaged by RAM II style PSUs

Made in the USA

Power/Data

Receives 24v DC and DXM/RDM from Wybron PS Series Power supply

XLR Connector Pin Out

XLR Pin #	Function	Conductor Size
1	Ground	14 AWG
2	Data +	22 AWG
3	Data -	22 AWG
4	24 Volts DC	14 AWG

**Not Compatible with Ram II Power Supplies*

Control

Uses DMX512-A Protocol

Infotrace features available using ANSI E1.20 - 2006 Remote Device Management over USITT DMX512 standard

Local control mode via keypad or remote pendant

Fin position /main address, user selectable 1-512

Parameters and features selectable with Infotrace/RDM:

Base Address
Operating personality
Firmware Upgrade

Infotrace/RDM feedback information

Aperture Light Sensor
Unit Temperature Sensor
Pass Through Current
Hours Since Last Maintenance
Fan Stopped
Fan RPM
High Motor Current
Voltage Sensor
Init Fail
Low Voltage Alert



Dimensions & Weights

1K ECLIPSE IT Model 89001

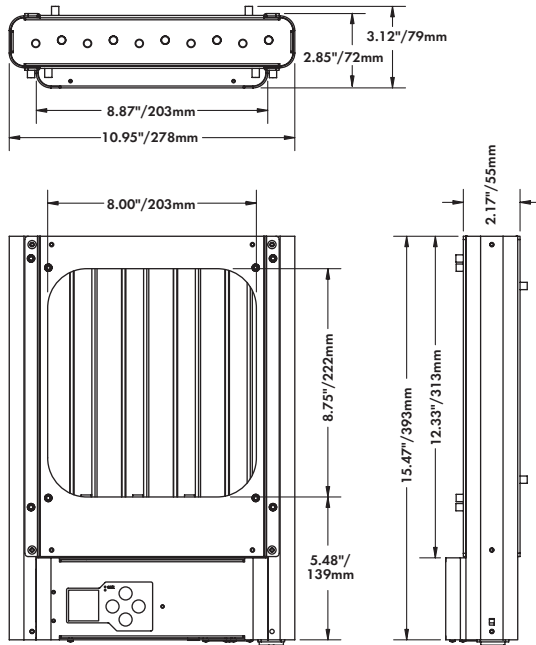

Weight: 5.52 lbs./2.51kg without mounting plate
Front Door: 6.25" accessory holder

2K ECLIPSE IT Model 811010

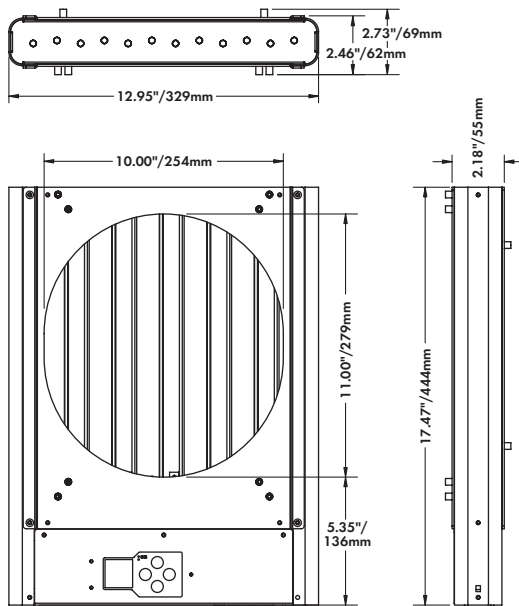

Weight: 5.62 lbs./2.55kg without mounting plate
Front Door: 14.0" accessory holder

Lrg. Frmt. ECLIPSE IT Model 817000

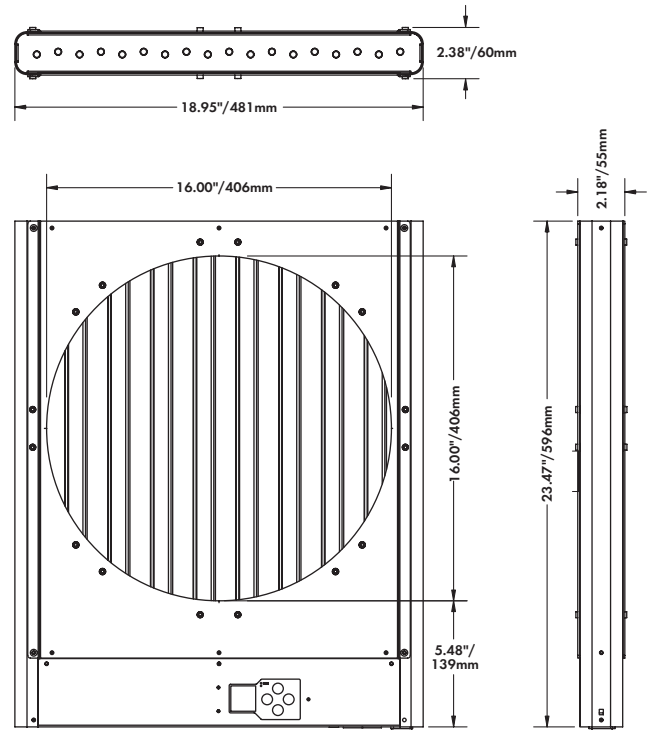

Weight: 6.16 lbs./2.79kg without mounting plate

Ordering Information

ECLIPSE IT Dowser	
Model	Description
89001	1K Dowser
811010	2K Dowser
817000	5K Dowser
PS-SERIES Power Supply	
820150	150W power Supply
820300	300W power Supply
820600	600W power Supply
ECLIPSE IT Accessories	
7042-XX	Power/Data Cable (XX=Length)*
ECLIPSE IT Mounting Plate INCLUDED. To specify size, see website.	

* Available in 3', 5', 10', 15', 25', 50', 75', & 100' lengths



Advancing The Art Of Lighting